

WWRM Mobile Barcode Scanning



Route Manager
by WORKWAVE®

WWRM Mobile Barcode Scanning Overview

To be the leader in the Last Mile Delivery Software



Value of Barcode Scanning

- All WWRM features designed around Saving Time & Money
- **Customer Need:**
 - Ensuring delivery accuracy
 - Streamline driver workflow
 - Reduce time at destination
 - Remove need of paperwork and minimize errors
- **Industry Focus: Food & Beverage, Courier & Parcel , Waste Management and Distribution.**
- **Makes us competitive in the industry**

Industry Stats

- 86% of shoppers are unlikely to buy products from a brand after an experience with inaccurate product data***
- Inventory inaccuracy accounts for 8.7% of lost sales***
- Order picking mistakes can cost \$22+
- The average company loses \$390,000 because of order mispicks+

Feature Requirements

- WWRM 360 or WWRM 360+
- Scenario 1. - Pickup Or Dropoff
- Scenario 2. - Pickup & Dropoff:
 - To Ensure Correct Package Is Loaded On Truck
 - To Ensure Correct Package Is Delivered to the final customer
- Maximum of **10*** Barcodes Per Order (20 for Pickup & Dropoff)
*from the Admin Panel it's possible to tweak that parameter per Account (max allowed value is 50)
- 1D and 2D* Barcodes Supported
*2D QR Codes limited to **100** characters
- No Additional Fee

How The Feature Works

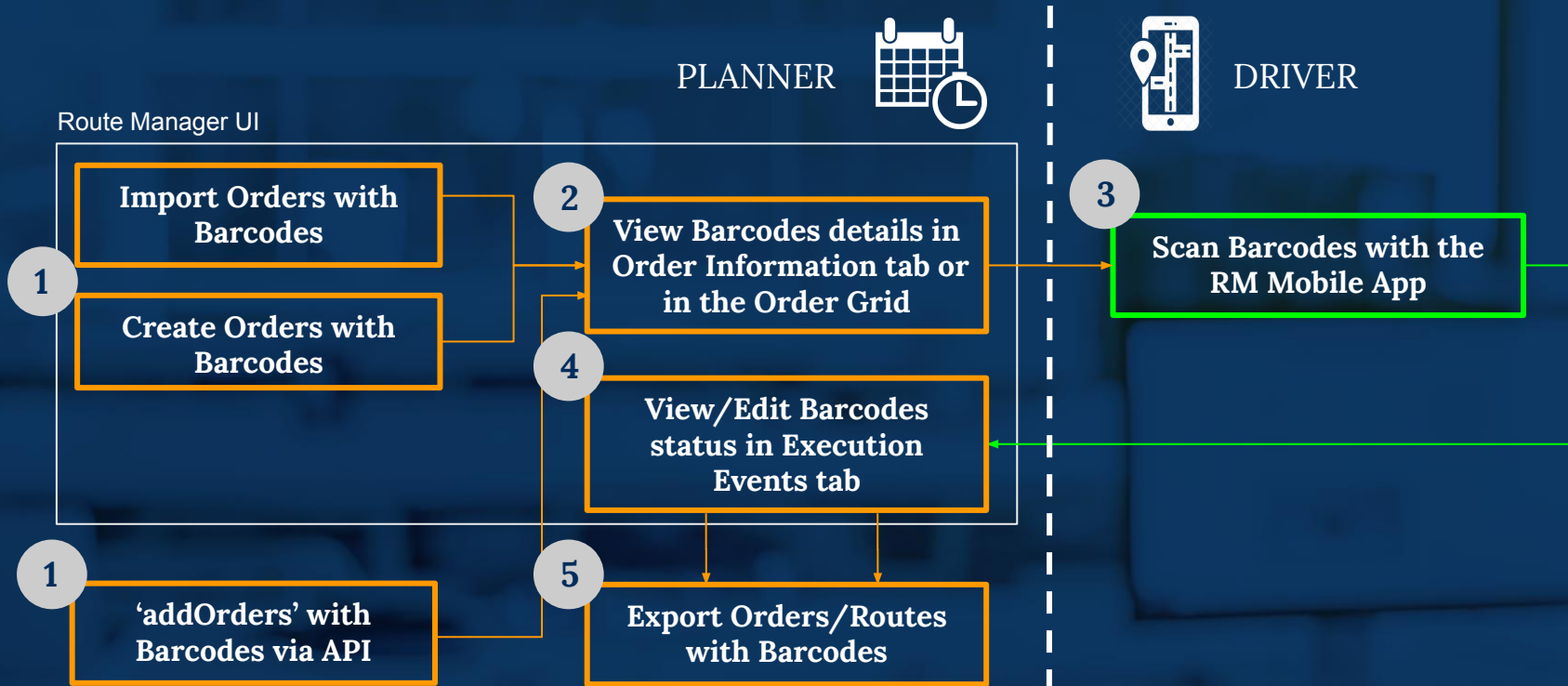



1 Planner | Import Wizard with Barcodes

Import Orders from: orders__New York 7AM (new) BARCODES.xlsx

Column Mapping

Eligibility, Eligibility Type, Importance, Required Vehicle, Load, Notes, Service Time, Tags: Required, Tags: Banned, Time Window Start 1, Time Window End 1, Time Window Start 2, Time Window End 2, Address: Depot name, Address: Full Address, Address: Street, Address: Zip, Address: City, Barcodes, Custom Field

Drag and Drop columns name to set fields that best co

You can add maximum 5 barcodes per single Pickup or Dropoff with max 100 characters.

Supported Formats:

- 1D product: UPC-A, UPC-E, EAN-8, EAN-13, UPC/EAN Extension 2/5
- 1D industrial: Code 39, Code 93, Code 128, Codebar, ITF
- 2D: QR Code, Data Matrix, Aztec (beta), PDF 417 (beta), MaxiCode, RSS-14, RSS-Expanded

File Column Names	Delivery Address	Delivery Service Time	Delivery Required
Example 1	NJ	Ok	40.862383
Example 2	218,	Ok	40.862383

Column Mapping	Barcode
Example 1	54321, aaaaa
Example 2	aaaaa, bbbbb, 12345



1 Planner | Create Orders with Barcodes

Barcodes input during single order creation

Custom Fields

[+ Add Custom fields](#)

Barcodes [Restore](#)

[+ Add Barcode](#)



1 Planner | Create Orders with Barcodes | Errors

Max 10 Barcodes per order-step

Barcodes [Restore](#)

+ Add Barcode

- 123445
- 123243
- 754658
- 574657
- 756758

The comma symbol is not allowed

Barcodes [Restore](#)

+ Add Barcode

- 123445
- 12332,34

Wrong format. Barcode can't contain , symbol

The max number of characters is 100

Barcodes [Restore](#)

+ Add Barcode

- 123445
- 123321233212332123321233212332123321233212332

Wrong Format. Barcode can't contain more than 100 characters



2 Planner | View Orders with Barcodes



Barcodes in read-only mode



If the barcode is too long, we'll show only the last digits (usually the most relevant)





2 Planner | Orders with Barcodes in the Order Grid

Barcodes in Order Grid

SERVICE TIME	STATUS	ASSIGNED TO	SCHEDULE TIME	BARCODES	PRIOR
3 hrs 0 mins	Assigned	Vehicle1	06:02	1/3 Scanned	Normal
30 mins	Unassigned	-	-	2	Normal



3 Barcodes

- 1 Scanned
- 0 Unscanned
- 1 Unreadable Barcode
- 0 Missing Barcodes
- 1 Missing Package

Order Grid

1/3 Scanned	Nor
2	Nor

When Order is assigned a tooltip will show more info about Barcodes' status



3 Driver | Scan Barcodes with the RM Mobile App | Setup & Visuals



Pickup & Drop Off Scenario

1. Required for validating that the right Order is Picked Up and Dropped Off (P&D)
2. '15' represents the total number of packages to be picked up
3. Number is greater than 5 because they are grouped together for pickup at Depot
4. Driver uses this P&D setup to ensure the right order is being added to the truck

Drop Off Or Pickup only Scenario

1. Driver has '3' Barcodes to scan for customer Susan Morris
2. Driver can click on the barcode icon to jump directly to the barcode list

Proof Of Delivery Screen

1. Driver has '3' Barcodes to scan which haven't been scanned yet
2. Driver can click on the barcode icon to jump directly to the barcode list

Visual Feedback on Barcode

1. **GREEN** highlights all Barcodes were successful scanned
2. **BLUE** highlights that - when the order is not marked as Done - some Barcodes were not scanned
3. **RED** highlights that - when the order is marked as Done - some Barcodes were not scanned



3 Driver | Scan Barcodes with the RM Mobile App | Validation of Scan



Barcode List

1. Smartphone's camera is automatically enabled to acquire the image
2. All the Barcodes that needs to be scanned are listed

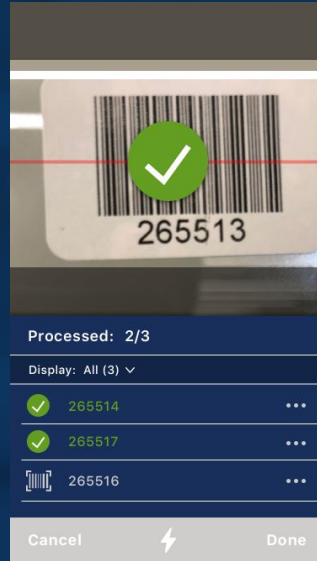

Barcode is present!

1. If the Barcode is assigned to that order, the app shows a successful icon
2. The smartphone also plays a successful sound
3. The Barcode is then set as "scanned" with a green tick

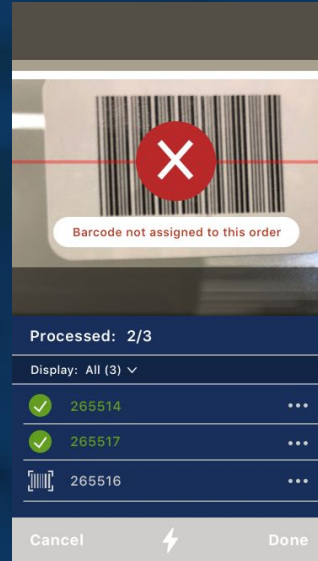

Barcode NOT present!

1. If the Barcode is NOT assigned to that order, the app shows an error icon and message
2. The smartphone also plays an error sound

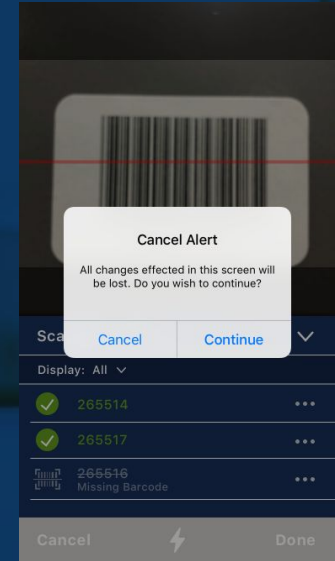

Exit Barcode List

1. Done saves the changes
2. Cancel discard the changes. An alert is shown if some changes are pending



3 Driver | Scan Barcodes with the RM Mobile App | Edit Scans

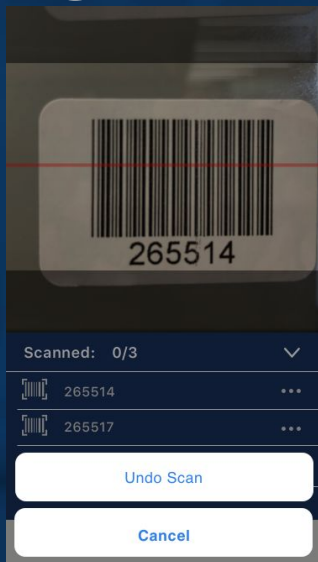

Undo a Scan

1. For already scanned Barcodes, the Driver can “undo” a scan
2. This will reset the Barcode’s status to unscanned

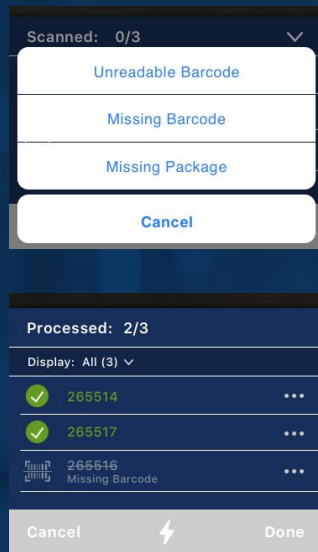

Set a reason for Unable to Scan Barcodes

1. For Barcodes that are Unable to Scan, the Driver can set a reason
2. That reason will be shown below the Barcode and also the icon will change

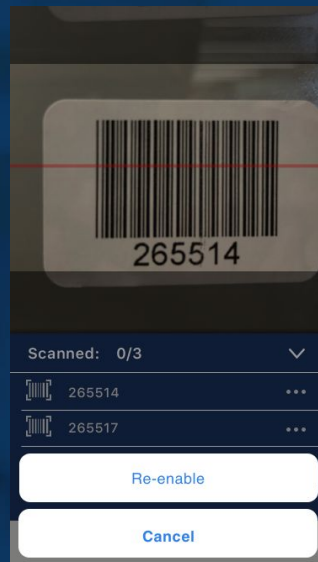

Re-enable a Barcode

1. For Barcodes set as Unable to Scan, the Driver can “re-enable” them
2. This will reset the Barcode’s status to unscanned

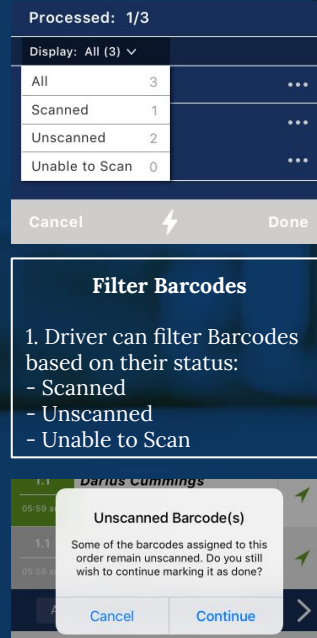

Warning Message

A Warning Message is displayed when there are one or more Unscanned Barcodes and the Order is marked as “Done”



4 Planner | View/Edit Barcodes status

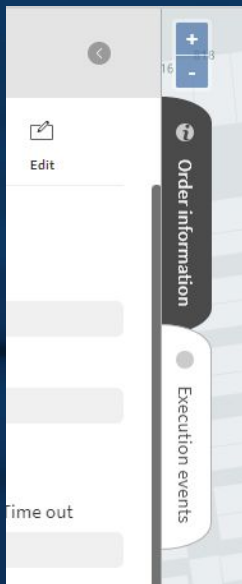

View Barcodes status

Barcodes	
Scanned (1)	
...4545645454545454874230943208943208472308472938432	09:11
Unreadable	
Missing Barcode (1)	
3456345	09:14
Missing Package (1)	
6767	09:13
Unscanned	

Edit Barcodes status

Barcodes	
...45433454343309874230943208943208472308472938432	09:11
Scanned	
Scanned	09:11
Missing Barcode	
Missing Package	
Unreadable	09:11
Unscanned	



4 Planner | View/Edit Barcodes status

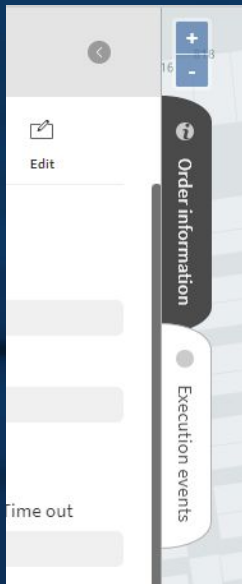

Barcode timestamp

Barcodes	
Scanned (3)	
aaaaa	11:45
bbbbb	11:45 10/03/2020 11:45
12345	11:45
Unreadable	
Missing Barcode	
Missing Package	
Unscanned	

On hover a title shows the full timestamp with also the date



5 Planner | Export Orders/Routes with Barcodes

Order Export: the Barcode Data are optional

Export Options
1 Order

FORMAT

CSV File (.csv) **Excel File (.xls)**

Barcode Data

Barcode Data Export

Exporting Orders with Barcode Data will add extra columns to the exported file. This might affect some of your integrations with the Exported Orders File

Cancel **Export**

The Barcode column will be appended at the end of the excel/csv with the Barcode values

Route Export: the Barcode Data are optional

Export Options
1 Route (1 Dispatched)

ROUTES TO EXPORT

Selected Dispatched

FORMAT

CSV File (.csv) **Excel File (.xls)**

Include Proofs of Delivery (if any)

Barcode Execution Data

Barcode Data Export

Exporting Routes with Barcode Data will add extra columns to the exported file. This might affect some of your integrations with the Exported Routes File

Cancel **Print** **Export**

The Barcode column will be appended at the end of the excel/csv with the Barcode values and status